



Setup Guide

VALVE INDEX CONTROLLERS

Welcome to Virtual Reality.

Valve Index is your access to the wondrous people, places, and things you'll interact with in the virtual worlds. While the Valve Index is infinite, thankfully its setup is not.

Let's get started!

1 Install SteamVR

If you're setting up VR for the first time, visit our website for comprehensive instructions and assistance.

Before setup, be sure your operating system and video drivers are up to date.

Download SteamVR from the website below and install it on your VR Ready PC.

Create or log into your Steam account before proceeding.



steamvr.steampowered.com



Read the enclosed safety information to reduce the risk of accidents such as tripping, falling, entanglement, collisions, or electrical and fire hazards.

2 Pair your controllers

Launch SteamVR by clicking the VR button in the upper corner of Steam.

To pair your controllers with your VR Headset, Select *Devices > Pair Controller*. Follow the on-screen instructions to complete the process.

Once paired, use the system button to turn on your controllers and launch SteamVR.

Note: Your controllers are partially charged for a few hours of playtime. To charge them, use the provided USB cables.

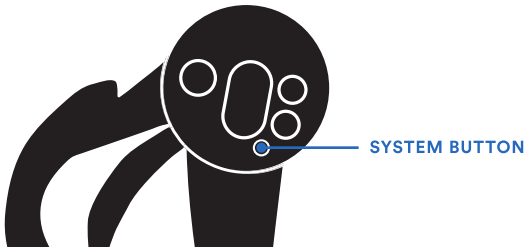



For additional setup and safety information,
visit our website.

steamvr.steampowered.com

Adjusting for fit & comfort



V003306-00

Wearing your controllers

For added security, attach the lanyards to your controller grips. Adjust each lanyard to secure the controller at your wrist.

Grip the controller, and using your other hand, pull the adjustment strap snug. To loosen it, press the release button.

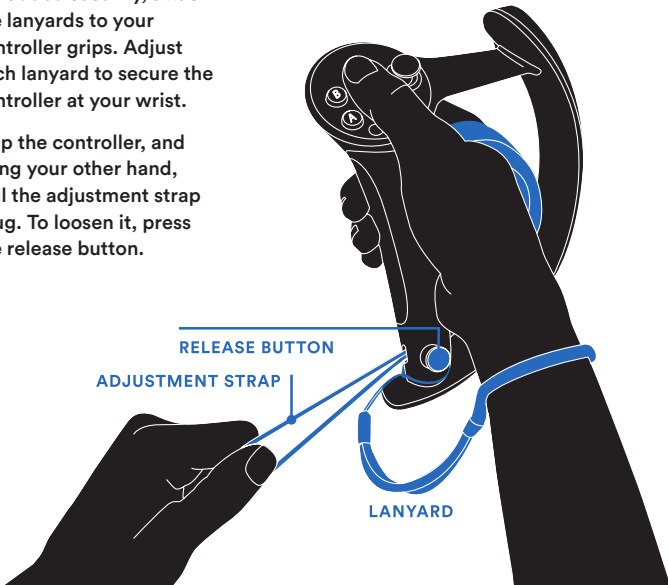

Adjusting your controllers for fit

To adjust for different hand sizes, push in the size adjustment arm, then swing it left or right.

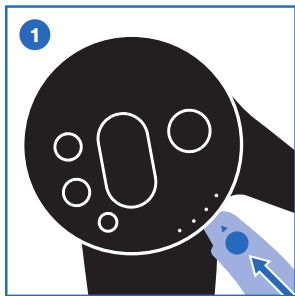

Push inward.

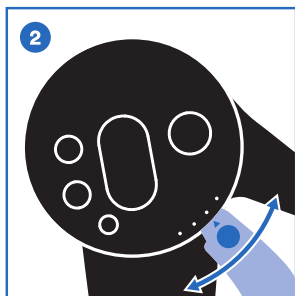

Larger hands? Swing down.
Smaller hands? Swing up.